



Specification:

- 1) Dielectric Breakdown Voltage: > 4 KV
- 2) Dielectric Constant: 0.5 °C·IN²/W
- 3) Thermal Conductivity: 0.8 W/mk
- 4) Operating Temperature: -40°C ~ 155°C
- 5) Flame Rating: UL-94V-0

TO-3P-x

Dimensions

none, B, C (see table below)

Insulating Transistor Case

3P - TOP3

220 - TO220

Transistor Insulating Tubes

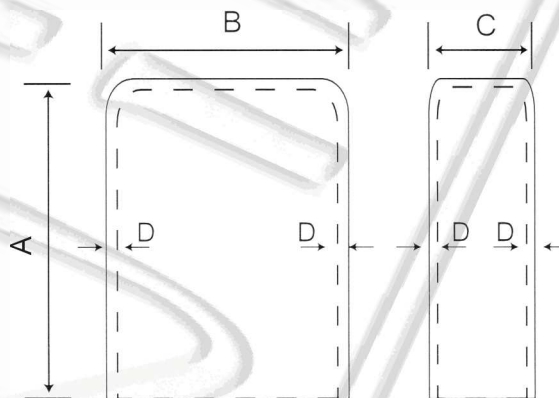

DIMENSIONS [mm]

Series No.	A	B	C	D
TO-220	21.5	11.5	5.9	0.5
TO-220-B	16	11.5	5.9	0.5
TO-220-C	21.8	12.1	6.5	0.8
TO-3P	28.5	17.5	5.9	0.5
TO-3P-B	28.8	18.2	6.6	0.8